

# TARIFA 2018

## Manguera Inox, Racores y Bridas soldables

*Stainless steel hose, welding fittings and forged flanges*

*Tuyau Inox, raccords et brides à souder*

*Tubi Inox, raccordi e flange a saldare*

### **Manguera Inox**

*Stainless steel hose*

*Tuyau Inox*

*Tubi inox*

165

### **Racores y Bridas soldables**

*Welding fittings and forged flanges*

*Raccords et brides à souder*

*Raccordi e flange a saldare*

167

# Manguera Inox

*Stainless steel hose*

Tuyau Inox

Tubi inox

■ Mangueras Inox Corrugado y Malla Inox / Convuluted stainless steel hoses and AISI 304 Braid / Tuyaux inox onduleux et Tresse Inox / Tubi Inox corrugato e Maglia Inox | 165



M93211



M93161304



M93161



M93161304.EF



M93212



M304

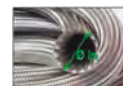

M3160

# Racores y Bridas soldables

*Welding fittings and forged flanges*  
*Raccords et brides à souder*  
*Raccordi e flange a saldare*

■ Racores soldables BSP /BSP Welding fittings /Raccords à souder BSP /Raccordi a saldare BSP | 167

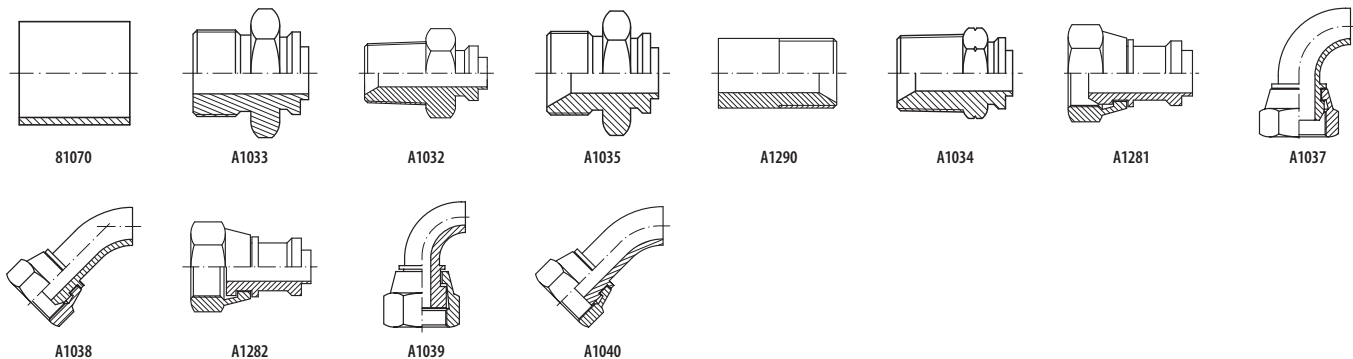

■ Racores soldables JIC 37º /JIC 37º Welding fittings /Raccords à souder JIC 37º /Raccordi a saldare JIC 37º | 169

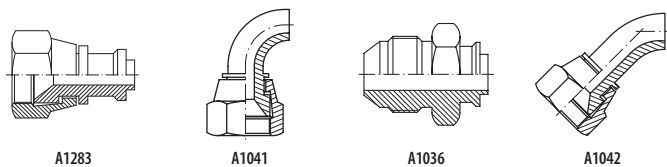

■ Racor soldable métrica /Metric Welding fittings /Raccords à souder métriques /Raccordi a saldare metrici | 170

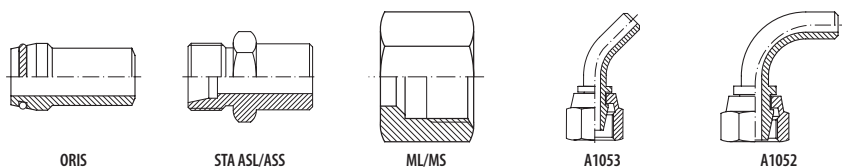

■ Cono y tuerca /Nipple and nut /Collet et écrou /Ogiva e dado | 172

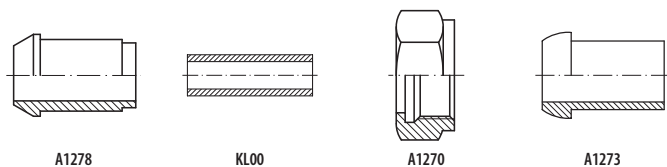

■ Racores para soldar >2" /Welding fittings >2" /Raccords à souder >2" /Raccordi a saldare > 2" | 172

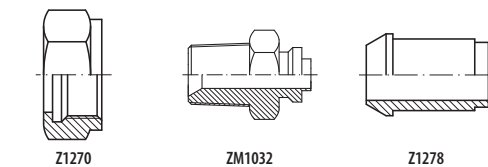

■ Bridas fijas para soldar /Fixed Forged flanges /Brides DIN à souder fixes /Flangia a saldare | 173

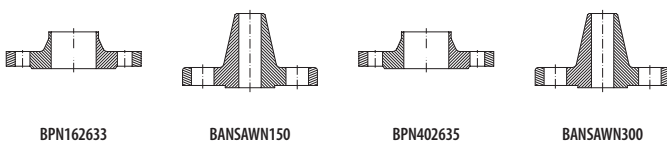

■ Conjunto brida DIN 2642 /DIN 2642 swivel flanges set /Ensemble brides tournantes DIN 2642 /Flangia girevole DIN 2642 | 174

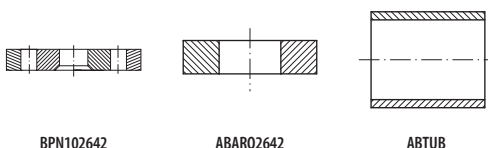

Industrial hoses

Industrial fittings

Stainless steel hose, welding fittings and forged flanges

Low pressure

Air conditioning hoses and fittings

# Racores y Bridas soldables

*Welding fittings and forged flanges*  
*Raccords et brides à souder*  
*Raccordi e flange a saldare*

- Conjunto brida DIN 2656 / DIN 2656 swivel flanges set / Ensemble brides tournantes DIN 2656 / Flangia girevole DIN 2656 | 175

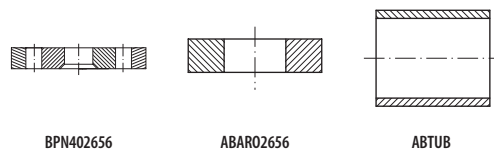

- Conjunto brida ANSI-ASA / ANSI-ASA swivel flanges set / Ensemble brides ANSI-ASA / Flangia girevole ANSI-ASA | 176

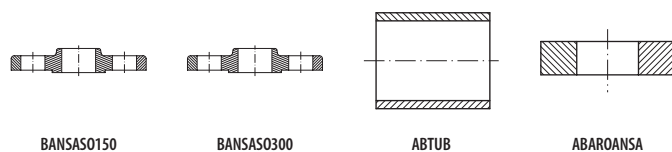

# Manguera Inox

Stainless steel hose  
Tuyau Inox  
Tubi inox

Industrial hoses

Industrial fittings

Stainless steel hose, welding fittings and forged flanges

Low pressure

Air conditioning hoses and fittings

## Inox corrugado AISI 321 con una malla AISI 304

Convuluted S.S. AISI 321 hose with one braid S.S. AISI 304

Inox onduleux AISI 321 avec une tresse inox AISI 304

Tubo in Inox corrugato 321 con una maglia AISI 304



DN	Ø INNER Ø INT.	Part nº Referencia	€
1/4"	6.2	M93211006	7,78
3/8"	10.3	M93211010	9,83
1/2"	12.2	M93211012	10,24
5/8"	16.2	M93211016	16,38
3/4"	20.2	M93211020	21,30
1"	25.4	M93211025	26,62
1" 1/4	34.3	M93211032	32,43
1" 1/2	40.1	M93211040	41,90
2"	50.3	M93211050	59,01
2" 1/2	65.6	M93211065	82,89
3"	80.3	M93211080	91,73
4"	100.8	M93211100	121,22

## Inox. corrugado AISI 316 con una malla AISI 304

Convuluted S.S. AISI 316 hose with one braid S.S. AISI 304

Inox onduleux AISI 316 avec une tresse inox AISI 304

Tubo in Inox corrugato 316 con una maglia AISI 304



DN	Ø INNER Ø INT.	Part nº Referencia	€
1/4"	6.2	M93161304006	7,78
3/8"	10.3	M93161304010	10,65
1/2"	12.2	M93161304012	11,22
3/4"	20.2	M93161304020	22,93
1"	25.4	M93161304025	29,49
1" 1/4	34.3	M93161304032	36,86
1" 1/2	40.1	M93161304040	49,96
2"	50.3	M93161304050	67,16
2" 1/2	65.6	M93161304065	94,60
3"	80.3	M93161304080	101,97
4"	100.8	M93161304100	138,83

## Inox corrugado AISI 316 con una malla AISI 316

Convuluted S.S. AISI 316 hose with one braid S.S. AISI 316

Inox onduleux AISI 316 avec une tresse inox AISI 316

Tubo in Inox corrugato 316 con una maglia AISI 316



DN	Ø INNER Ø INT.	Part nº Referencia	€
1/4"	6,2	M93161006	12,16
3/8"	10,3	M93161010	14,42
1/2"	12,2	M93161012	17,12
3/4"	20,2	M93161020	32,43
1"	25,4	M93161025	38,29
1" 1/4	34,3	M93161032	58,56
1" 1/2	40,1	M93161040	67,57
2"	50,3	M93161050	90,10
2" 1/2	65,6	M93161065	121,63
3"	80,3	M93161080	141,45
4"	100,8	M93161100	186,05

## Inox. corrugado AISI 316 con una malla AISI 304 extra flexible

Convuluted S.S. AISI 316 hose with one braid S.S. AISI 304 extra flexible

Inox onduleux AISI 316 avec une tresse inox AISI 304 extra flexible

Tubo inox corrugato AISI 316 con una treccia inox AISI 304 extra flessibile



DN	Ø INNER Ø INT.	Part nº Referencia	€
3/4"	20	M93161304020EF	25,77
1"	25	M93161304025EF	33,24
1" 1/4	34.3	M93161304032EF	43,41
1" 1/2	39.8	M93161304040EF	59,69
2"	50	M93161304050EF	80,04

## Inox corrugado AISI 321 con dos mallas AISI 304

Convuluted S.S. AISI 321 hose with two braids S.S. AISI 304

Inox onduleux AISI 321 avec deux tresses inox AISI 304

Tubo in Inox corrugato 321 con due maglie AISI 304



DN	Ø INNER Ø INT.	Part nº Referencia	€
1/4"	6,2	M93212006	11,71
3/8"	10,3	M93212010	13,51
1/2"	12,2	M93212012	14,87
3/4"	20,2	M93212020	30,63
1"	25,4	M93212025	38,74
1" 1/4	34,3	M93212032	45,95
1" 1/2	40,1	M93212040	60,81
2"	50,3	M93212050	86,04
2" 1/2	65,6	M93212065	116,67
3"	80,3	M93212080	134,24
4"	100,8	M93212100	174,79

# Manguera Inox

Stainless steel hose

Tuyau Inox

Tubi inox

## Malla inox 304

AISI 304 braid

Tresse inox 304



Maglia di acciaio Inox 304

Ø INNER Ø INT.	Part nº Referencia	€
9,6	<b>M304009.6</b>	<b>3,69</b>
12,3	<b>M304012.3</b>	<b>4,10</b>
14,3	<b>M304014.3</b>	<b>4,51</b>
16,7	<b>M304016.7</b>	<b>4,91</b>
21,6	<b>M304021.6</b>	<b>9,42</b>
26,8	<b>M304026.8</b>	<b>10,65</b>
32,2	<b>M304032.2</b>	<b>12,70</b>
41,1	<b>M304041.1</b>	<b>18,84</b>
49,8	<b>M304049.8</b>	<b>22,93</b>
60,3	<b>M304060.3</b>	<b>29,49</b>
80,8	<b>M304080.8</b>	<b>41,77</b>

## Malla inox 316

AISI 316 braid

Tresse inox 316

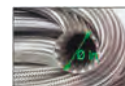

Maglia di acciaio Inox 316

Ø INNER Ø INT.	Part nº Referencia	€
9,6	<b>M316009.6</b>	<b>4,91</b>
12,3	<b>M316012.3</b>	<b>5,32</b>
14,3	<b>M316014.3</b>	<b>6,14</b>
16,7	<b>M316016.7</b>	<b>6,55</b>
21,6	<b>M316021.6</b>	<b>12,29</b>
26,8	<b>M316026.8</b>	<b>13,92</b>
32,2	<b>M316032.2</b>	<b>16,38</b>
41,1	<b>M316041.1</b>	<b>24,57</b>
49,8	<b>M316049.8</b>	<b>29,90</b>
60,3	<b>M316060.3</b>	<b>38,50</b>
80,8	<b>M316080.8</b>	<b>54,47</b>

# Racores y Bridas soldables

*Welding fittings and forged flanges*  
*Raccords et brides à souder*  
*Raccordi e flange a saldare*

Industrial hoses

Industrial fittings

Stainless steel hose, welding fittings and forged flanges

Low pressure

Air conditioning hoses and fittings

## Casquillo soldable Inox corrugado

*Convuluted SS welding ferrule*

*Jupe à souder Inox convoluté*

*Boccola a saldare per inox corrugato*

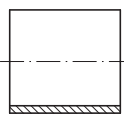

DN	Ø INNER Ø INT.	Part nº Referencia	€
1/4"	14	810700400	*
1/4"	12	810700401	*
3/8"	19	810700600	*
3/8"	17	810700601	*
1/2"	22	810700800	*
1/2"	19	810700801	*
5/8"	25	810701000	*
3/4"	30	810701200	*
3/4"	32	810701201	*
1"	35	810701500	*
1"	38	810701600	*
1 1/4"	47,8	810702000	*
1 1/4"	44,3	810702001	*
1 1/2"	56,1	810702400	*
2"	66	810703201	*
2 1/2"	84,8	810704000	*
2 1/2"	95,6	810704001	*
3"	100	810704801	*
4"	125	810706400	*

Ver precios en Tarifa Inox p.167 / Prices in Stainless Steel Catalogue p.167 / Prix dans le Catalogue Acier Inox p.167 / Prezzi in Acciaio Inossidabile p.167

## Macho fijo BSP asiento plano - soldable con guía

*Welding fixed male BSP flat seat with guide*

*Mâle fixe BSP fond plat à souder avec guide*

*Maschio BSP faccia piana, a saldare con guida*

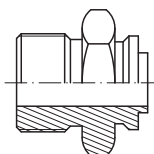

DN	THREAD ROSCA	Part nº Referencia	€
1/4"	1/4" BSP	A103304	1,78
3/8"	3/8" BSP	A103306	2,16
1/2"	1/2" BSP	A103308	2,84
3/4"	3/4" BSP	A103312	4,11
1"	1" BSP	A103316	6,70
1 1/4"	1 1/4" BSP	A103320	13,51
1 1/2"	1 1/2" BSP	A103324	17,58
2"	2" BSP	A103332	27,32

## Macho cónico BSPT con guía

*Welding adaptor BSPT with guide*

*Mamelon hexagonal BSPT conique à souder (bw) + guide*

*Maschio conico BSPT con guida*

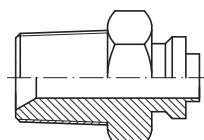

DN	THREAD ROSCA	Part nº Referencia	€
1/4"	1/4" BSPT	A103204	2,27
3/8"	3/8" BSPT	A103206	2,57
1/2"	1/2" BSPT	A103208	3,67
3/4"	3/4" BSPT	A103212	3,90
1"	1" BSPT	A103216	6,41
1 1/4"	1 1/4" BSPT	A103220	16,28
1 1/2"	1 1/2" BSPT	A103224	16,07
2"	2" BSPT	A103232	22,40
2 1/2"	2 1/2" BSPT	A103240	67,50

## Macho BSP cono 60º con guía

*Welding adaptor BSP 60º with guide*

*Mamelon hexagonal BSP à souder (bw) + guide*

*Maschio BSP a saldare sede 60º con guida*

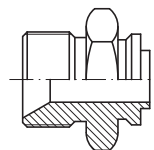

DN	THREAD ROSCA	Part nº Referencia	€
1/4"	1/4" BSP	A103504	1,18
3/8"	3/8" BSP	A103506	1,38
1/2"	1/2" BSP	A103508	1,97
3/4"	3/4" BSP	A103512	3,25
1"	1" BSP	A103516	4,74
1 1/4"	1 1/4" BSP	A103520	10,86
1 1/2"	1 1/2" BSP	A103524	15,20
2"	2" BSP	A103532	31,66

## Empalme liso soldable rosca BSP (60º)

*Welding union BSP male (60º)*

*Embout mâle lisse à souder gaz cyl BSP (60º)*

*Mezzo nipples tondo a saldare BSP 60º*

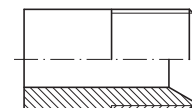

THREAD ROSCA	Part nº Referencia	€
1/8" BSP	A129002	1,32
1/4" BSP	A129004	0,77
3/8" BSP	A129006	0,93
1/2" BSP	A129008	1,16
3/4" BSP	A129012	2,04
1" BSP	A129016	4,94
1 1/4" BSP	A129020	15,74
1 1/2" BSP	A129024	16,65
2" BSP	A129032	15,93

## Macho fijo NPT - soldable con guía

*Welding fixed male NPT flat seat with guide*

*Mâle fixe NPT à souder avec guide*

*Maschio NPT, a saldare con guida*

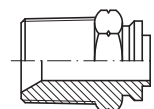

DN	THREAD ROSCA	Part nº Referencia	€
1/4"	1/4" NPT	A103404	1,47
3/8"	3/8" NPT	A103406	2,15
1/2"	1/2" NPT	A103408	2,43
3/4"	3/4" NPT	A103412	3,89
1"	1" NPT	A103416	6,49
1 1/4"	1 1/4" NPT	A103420	12,61
1 1/2"	1 1/2" NPT	A103424	14,66
2"	2" NPT	A103432	30,81

# Racores y Bridas soldables

Welding fittings and forged flanges  
Raccords et brides à souder  
Raccordi e flange a saldare

## Hembras giratorias prensada BSP 60° - soldable con guía

Welding BSP swivel female 60° with guide

Femelle tournante BSP 60° à souder avec guide

Femmina diritta girevole BSP, a saldare con guida

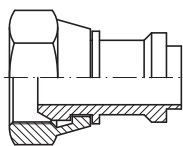

DN	THREAD ROSCA	Part nº Referencia	€
1/4"	1/4" BSP	A128104	1,52
3/8"	3/8" BSP	A128106	1,90
1/2"	1/2" BSP	A128108	2,70
3/4"	3/4" BSP	A128112	4,19
1"	1" BSP	A128116	6,58
1" 1/4	1" 1/4 BSP	A128120	11,18
1" 1/2	1" 1/2 BSP	A128124	14,67

## Hembras giratorias prensada 90° BSP 60° - soldable

Welding 90° BSP swivel female 60°

Femelle tournante 90° à souder

Femmina 90° girevole BSP, a saldare

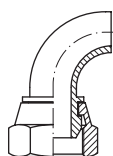

DN	THREAD ROSCA	Part nº Referencia	€
1/4"	1/4" BSP	A103704	2,43
3/8"	3/8" BSP	A103706	3,09
1/2"	1/2" BSP	A103708	5,12
3/4"	3/4" BSP	A103712	7,57
1"	1" BSP	A103716	12,35
1" 1/4	1" 1/4 BSP	A103720	20,45
1" 1/2	1" 1/2 BSP	A103724	29,42
2"	2" BSP	A103732	50,01

## Hembras giratorias prensada 45° BSP 60° - soldable

Welding 45° BSP swivel female 60°

Femelle tournante 45° à souder

Femmina 45° girevole BSP, a saldare

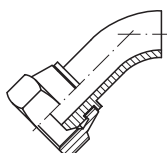

DN	THREAD ROSCA	Part nº Referencia	€
1/4"	1/4" BSP	A103804	2,47
3/8"	3/8" BSP	A103806	3,24
1/2"	1/2" BSP	A103808	4,63
3/4"	3/4" BSP	A103812	8,88
1"	1" BSP	A103816	12,35
1" 1/4	1" 1/4 BSP	A103820	19,86
1" 1/2	1" 1/2 BSP	A103824	29,42
2"	2" BSP	A103832	50,01

## Hembras giratorias prensada BSP asiento plano - soldable con guía

Welding BSP swivel female flat seat

Femelle tournante BSP à souder fond plat

Femm. gir. BSP faccia piana, a saldare con guida

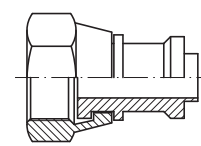

DN	THREAD ROSCA	Part nº Referencia	€
1/4"	1/4" BSP	A128204	1,73
3/8"	3/8" BSP	A128206	2,16
1/2"	1/2" BSP	A128208	3,72
3/4"	3/4" BSP	A128212	5,36
1"	1" BSP	A128216	8,99
1" 1/4	1" 1/4 BSP	A128220	16,26
1" 1/2	1" 1/2 BSP	A128224	23,78
2"	2" BSP	A128232	39,95

## Hembras giratorias prensada 90° BSP asiento plano - soldable

Welding 90° BSP swivel female 60° flat seat

Femelle tournante 90° à souder fond plat

Femm. 90° gir. BSP faccia piana, a saldare



DN	THREAD ROSCA	Part nº Referencia	€
1/4"	1/4" BSP	A103904	2,85
3/8"	3/8" BSP	A103906	3,63
1/2"	1/2" BSP	A103908	5,19
3/4"	3/4" BSP	A103912	9,94
1"	1" BSP	A103916	12,35
1" 1/4	1" 1/4 BSP	A103920	22,23
1" 1/2	1" 1/2 BSP	A103924	32,94
2"	2" BSP	A103932	55,99

## Hembras giratorias prensada 45° BSP asiento plano - soldable

Welding 45° BSP swivel female 60° flat seat

Femelle tournante 45° à souder fond plat

Femm. 45° gir. BSP faccia piana, a saldare

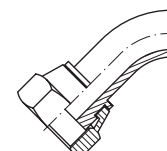

DN	THREAD ROSCA	Part nº Referencia	€
1/4"	1/4" BSP	A104004	3,03
3/8"	3/8" BSP	A104006	4,13
1/2"	1/2" BSP	A104008	5,62
3/4"	3/4" BSP	A104012	9,94
1"	1" BSP	A104016	12,35
1" 1/4	1" 1/4 BSP	A104020	22,23
1" 1/2	1" 1/2 BSP	A104024	32,94
2"	2" BSP	A104032	55,99



# Racores y Bridas soldables

*Welding fittings and forged flanges*  
*Raccords et brides à souder*  
*Raccordi e flange a saldare*

## Hembra giratoria prensada JIC 37° - soldable con guía

*Crimped JIC 37° swivel female weldable*

*Embout à sertir femelle tournante JIC37° à souder*

*Femmina girevole JIC 37°, a saldare*

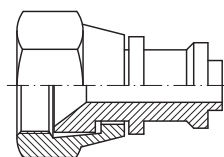

DN	THREAD ROSCA	Part nº Referencia	€
1/4"	7/16" 20h UNF	A12830704	1,54
1/4"	1/2" 20h UNF	A12830804	1,85
3/8"	9/16" 18h UNF	A12830906	2,01
3/8"	3/4" 16h UNF	A12831206	2,94
1/2"	3/4" 16h UNF	A12831208	2,94
1/2"	7/8" 14h UNF	A12831408	3,17
3/4"	1" 1/16 12h UNF	A12831712	4,79
1"	1" 5/16 12h UNF	A12832116	8,50
1" 1/4	1" 5/8 12h UNF	A12832620	14,06
1" 1/2	1" 7/8 12h UNF	A12833024	21,24

## Hembra giratoria 90° prensada JIC 37° - soldable

*Welding 90° JIC 37° swivel female*

*Femelle tournante 90° JIC 37° à souder*

*Femmina 90° girevole JIC 37°, a saldare*



DN	THREAD ROSCA	Part nº Referencia	€
1/4"	7/16" 20h UNF	A10410704	2,59
1/4"	1/2" 20h UNF	A10410804	3,03
3/8"	9/16" 18h UNF	A10410906	3,63
1/2"	3/4" 16h UNF	A10411208	5,19
1/2"	7/8" 14h UNF	A10411408	5,91
3/4"	1" 1/16 12h UNF	A10411712	8,11
1"	1" 5/16 12h UNF	A10412116	13,51
1" 1/4	1" 5/8 12h UNF	A10412620	26,28
1" 1/2	1" 7/8 12h UNF	A10413024	37,61

## Macho JIC 37° - soldable con guía

*Welding JIC 37° male with guide*

*Mâle JIC 37° à souder avec guide*

*Maschio JIC 37° a saldare con guida*

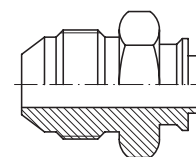

DN	THREAD ROSCA	Part nº Referencia	€
1/4"	7/16" 20h UNF	A10360704	1,44
1/4"	1/2" 20h UNF	A10360804	2,08
3/8"	9/16" 18h UNF	A10360906	1,78
3/8"	3/4" 16h UNF	A10361206	2,69
1/2"	3/4" 16h UNF	A10361208	2,69
1/2"	7/8" 14h UNF	A10361408	3,09
5/8"	7/8" 14h UNF	A10361410	3,46
3/4"	1" 1/16 12h UNF	A10361712	5,02
1"	1" 5/16 12h UNF	A10362116	10,38
1" 1/4	1" 5/8 12h UNF	A10362620	17,12
1" 1/4	1" 7/8 12h UNF	A10363020	22,22

## Hembra giratoria 45° prensada JIC 37° - soldable

*Welding 45° JIC 37° swivel female*

*Femelle tournante 45° JIC 37° à souder*

*Femmina 45° girevole JIC 37°, a saldare*

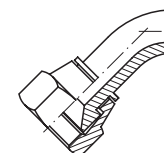

DN	THREAD ROSCA	Part nº Referencia	€
1/4"	7/16" 20h UNF	A10420704	2,85
1/4"	1/2" 20h UNF	A10420804	3,03
3/8"	9/16" 18h UNF	A10420906	3,72
1/2"	3/4" 16h UNF	A10421208	5,27
1/2"	7/8" 14h UNF	A10421408	6,57
3/4"	1" 1/16 12h UNF	A10421712	8,82
1"	1" 5/16 12h UNF	A10422116	13,98
1" 1/4	1" 5/8 12h UNF	A10422620	26,46
1" 1/2	1" 7/8 12h UNF	A10423024	38,91

Industrial hoses

Industrial fittings

Stainless steel hose, welding fittings and forged flanges

Low pressure

Air conditioning hoses and fittings

# Racores y Bridas soldables

Welding fittings and forged flanges  
Raccords et brides à souder  
Raccordi e flange a saldare

## Boquilla para soldar

Welding nipple

Collet cône Métrique (DIN 2353) à souder (BW)  
o'ring

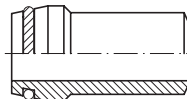

Ogiva a saldare

PIPE TUBO	SERIE	Part nº Referencia	€
15	L	ORIL 15	*
18	L	ORIL 18	*
22	L	ORIL 22	*
28	L	ORIL 28	*
8	S	ORIS 8X1.5	*
10	S	ORIS 10X2	*
12	S	ORIS 12X2.5	*
14	S	ORIS 14X2	*
14	S	ORIS 14X3	*
16	S	ORIS 16X2	*
16	S	ORIS 16X2.5	*
16	S	ORIS 16X3	*
20	S	ORIS 20X2.5	*
20	S	ORIS 20X3	*
20	S	ORIS 20X4	*
25	S	ORIS 25X4	*
30	S	ORIS 30X4	*
30	S	ORIS 30X5	*
38	S	ORIS 38X5	*

\*Ver precios en pág. 221 / \*See prices page 221 / \*Voir les prix page 221 / \*Vedere prezzi p. 221

## Racor recto para soldar

Weldable straight coupling

Raccord droit à souder

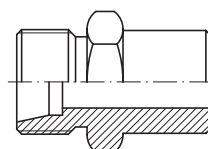

Raccordo diritto a saldare

PIPE TUBO	SERIE	Part nº Referencia	€
6	L	STA ASL 6	*
8	L	STA ASL 8	*
10	L	STA ASL 10	*
12	L	STA ASL 12	*
15	L	STA ASL 15	*
18	L	STA ASL 18	*
22	L	STA ASL 22	*
28	L	STA ASL 28	*
35	L	STA ASL 35	*
42	L	STA ASL 42	*
6	S	STA ASS 6	*
8	S	STA ASS 8	*
10	S	STA ASS 10	*
12	S	STA ASS 12	*
14	S	STA ASS 14	*
16	S	STA ASS 16	*
20	S	STA ASS 20	*
25	S	STA ASS 25	*
30	S	STA ASS 30	*
38	S	STA ASS 38	*

\*Ver precios en pág. 221 / \*See prices page 221 / \*Voir les prix page 221 / \*Vedere prezzi p. 221

## Tuerca Métrica DIN 3870

Nuts DIN 3870

Écrou Métrique DIN 3870

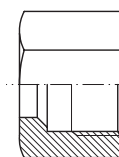

Dadi Metrici DIN 3870

PIPE TUBO	SERIE	THREAD ROSCA	Part nº Referencia	€
4	LL	M8x1	MLL 4 M 8X1	*
6	LL	M10x1	MLL 6 M 10X1	*
8	LL	M12x1	MLL 8 M 12X1	*
6	L	M12x1,5	ML 6 M 12X1.5	*
8	L	M14x1,5	ML 8 M 14X1.5	*
10	L	M16x1,5	ML 10 M 16X1.5	*
12	L	M18x1,5	ML 12 M 18X1.5	*
15	L	M22x1,5	ML 15 M 22X1.5	*
18	L	M26x1,5	ML 18 M 26X1.5	*
22	L	M30x2	ML 22 M 30X2	*
28	L	M36x2	ML 28 M 36X2	*
35	L	M45x2	ML 35 M 45X2	*
42	L	M52x2	ML 42 M 52X2	*
6	S	M14x1,5	MS 6 M 14X1.5	*
8	S	M16x1,5	MS 8 M 16X1.5	*
10	S	M18x1,5	MS 10 M 18X1.5	*
12	S	M20x1,5	MS 12 M 20X1.5	*
14	S	M22x1,5	MS 14 M 22X1.5	*
16	S	M24x1,5	MS 16 M 24X1.5	*
20	S	M30x2	MS 20 M 30X2	*
25	S	M36x2	MS 25 M 36X2	*
30	S	M42x2	MS 30 M 42X2	*
38	S	M52x2	MS 38 M 52X2	*

\*Ver precios en pág. 210 / \*See prices page 210 / \*Voir les prix page 210 / \*Vedere prezzi p. 210

## Racores y Bridas soldables

*Welding fittings and forged flanges*

*Raccords et brides à souder*

*Raccordi e flange a saldare*

### Hembra giratoria 45 pasada métrica - soldable

*Metric weldable swivel female 45°*

*Femelle tournante 45° métrique à souder*

*Femmina girevole 45° metrica a saldare*

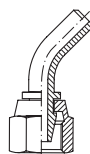

PIPE TUBO	SERIE	THREAD ROSCA	Part nº Referencia	€
6	L	12X1,5	<b>A10531206</b>	<b>4,32</b>
8	L	14x1,5	<b>A10531408</b>	<b>2,55</b>
10	L	16X1,5	<b>A10531610</b>	<b>3,20</b>
12	L	18X1,5	<b>A10531812</b>	<b>3,17</b>
15	L	22X1,5	<b>A10532215</b>	<b>4,56</b>
18	L	26X1,5	<b>A10532618</b>	<b>6,90</b>
22	L	30X2	<b>A10533022</b>	<b>9,65</b>
28	L	36X2	<b>A10533628</b>	<b>18,16</b>
35	L	45X2	<b>A10534535</b>	<b>27,93</b>
42	L	52X2	<b>A10535242</b>	<b>46,00</b>
6	S	14x1,5	<b>A10531406</b>	<b>4,32</b>
8	S	16X1,5	<b>A10531608</b>	<b>3,29</b>
10	S	18X1,5	<b>A10531810</b>	<b>3,46</b>
12	S	20X1,5	<b>A10532012</b>	<b>4,32</b>
14	S	22X1,5	<b>A10532214</b>	<b>5,02</b>
16	s	24x1,5	<b>A10532416</b>	<b>5,41</b>
20	S	30X2	<b>A10533020</b>	<b>10,52</b>
25	S	36X2	<b>A10533625</b>	<b>15,13</b>
30	S	42X2	<b>A10534230</b>	<b>23,78</b>
38	S	52X2	<b>A10535238</b>	<b>38,04</b>

### Hembra giratoria 90 pasada métrica - soldable

*Metric weldable swivel female 90°*

*Femelle tournante 90° métrique à souder*

*Femmina girevole 90° metrica a saldare*

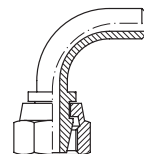

PIPE TUBO	SERIE	THREAD ROSCA	Part nº Referencia	€
6	L	12X1,5	<b>A10521206</b>	<b>4,32</b>
8	L	14X1,5	<b>A10521408</b>	<b>2,85</b>
10	L	16X1,5	<b>A10521610</b>	<b>3,20</b>
12	L	18X1,5	<b>A10521812</b>	<b>3,46</b>
15	L	22X1,5	<b>A10522215</b>	<b>5,02</b>
18	L	26X1,5	<b>A10522618</b>	<b>7,72</b>
22	L	30X2	<b>A10523022</b>	<b>11,07</b>
28	L	36X2	<b>A10523628</b>	<b>18,16</b>
35	L	45X2	<b>A10524535</b>	<b>27,84</b>
42	L	52X2	<b>A10525242</b>	<b>46,00</b>
6	S	14X1,5	<b>A10521406</b>	<b>4,32</b>
8	S	16X1,5	<b>A10521608</b>	<b>3,20</b>
10	S	18X1,5	<b>A10521810</b>	<b>3,46</b>
12	S	20X1,5	<b>A10522012</b>	<b>3,86</b>
14	S	22X1,5	<b>A10522214</b>	<b>5,02</b>
16	S	24X1,5	<b>A10522416</b>	<b>5,41</b>
20	S	30X2	<b>A10523020</b>	<b>9,40</b>
25	S	36X2	<b>A10523625</b>	<b>15,13</b>
30	S	42X2	<b>A10524230</b>	<b>23,78</b>
38	S	52X2	<b>A10525238</b>	<b>38,04</b>

# Racores y Bridas soldables

Welding fittings and forged flanges  
Raccords et brides à souder  
Raccordi e flange a saldare

## Cono ajuste 60° con guía

Welding nipple 60° cone for BSP nut with guide

Collet cône 60° à souder (bw) + guide

Nipplo a saldare sede 60° per dado BSP con guida

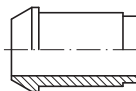

DN	THREAD ROSCA	Part nº Referencia	€
1/2"	1/2" BSP	A127808	1,46
3/4"	3/4" BSP	A127812	2,15
1"	1" BSP	A127816	2,57
1"1/4	1"1/4 BSP	A127820	5,84
1"1/2	1"1/2 BSP	A127824	8,19

## Espiga lisa métrica recta

Metric standpipe

Embout lisse métrique droit

Estremitá tubolare diritta Metrica



Ø OUTER ØEXT.	Ø INNER ØINT.	Part nº Referencia	€
6	4	KL0006	0,97
8	4	KL0008	0,97
10	6	KL0010	1,37
12	8	KL0012	6,81
14	10	KL0014	3,72
15	11	KL0015	2,63
16	11	KL0016	2,87
18	14	KL0018	4,14
20	12	KL0020	0,64
22	18	KL0022	7,94

## Tuerca para cono ajuste 60° BSP

BSP nut for welding nipple 60° cone

Écrou BSP pour collet à souder bw (60°)

Dado BSP per nipplo a saldare 60°



THREAD ROSCA	Part nº Referencia	€
1/4" BSP	A127004	0,94
3/8" BSP	A127006	0,89
1/2" BSP	A127008	1,13
3/4" BSP	A127012	1,30
1" BSP	A127016	2,96
1"1/4 BSP	A127020	6,03
1"1/2 BSP	A127024	8,31
2" BSP	A127032	12,46

## Cono ajuste sin guía

Welding nipple without guide

Collet à souder sans guide

Ogiva a saldare BSP

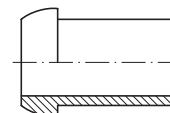

DN	THREAD ROSCA	Part nº Referencia	€
1/4"	1/4" BSP	A127304	0,55
3/8"	3/8" BSP	A127306	0,55
1/2"	1/2" BSP	A127308	1,16
3/4"	3/4" BSP	A127312	1,30
1"	1" BSP	A127316	2,24
1"1/4	1"1/4 BSP	A127320	3,32
1"1/2	1"1/2 BSP	A127324	5,71
2"	2" BSP	A127332	8,52

## Tuercas BSP Microfundido AISI-316 >2"

Micro-casting BSP nuts AISI-316 >2"

Écrou BSP en acier moulé AISI-316 >2"

Dadi BSP microfusi AISI-316 >2"

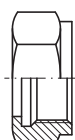

THREAD ROSCA	Part nº Referencia	€
2"1/2 BSP	Z127040	*
3" BSP	Z127048	*
4" BSP	Z127064	*

Ver precios en Tarifa Inox p.172 / Prices in Stainless Steel Catalogue p.172 / Prix dans le Catalogue Acier Inox p.172 / Prezzi in Acciaio Inossidabile p.172

## Cono ajuste BSP 60° con guía >2"

Welding nipple with 60° cone for BSP nut with guide >2"

Collet à souder BSP cone 60° avec guide >2"

Ogiva a saldare cono 60° con guida per dado BSP >2"

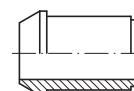

DN	THREAD ROSCA	Part nº Referencia	€
2"1/2	2"1/2 BSP	Z127840	*
3"	3" BSP	Z127848	*
4"	4" BSP	Z127864	*

Ver precios en Tarifa Inox p.172 / Prices in Stainless Steel Catalogue p.172 / Prix dans le Catalogue Acier Inox p.172 / Prezzi in Acciaio Inossidabile p.172

## Macho BSPT soldar microfundido AISI-316 >2"

Micro-casting BSPT welding male AISI-316 >2"

Mâle BSPT à souder en acier moulé AISI-316 >2"

Maschio BSPT a saldare microfuso AISI-316 >2"

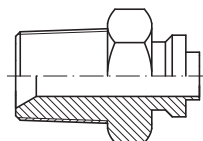

DN	THREAD ROSCA	Part nº Referencia	€
2"1/2	2"1/2 BSPT	ZM103240	*
3"	3" BSPT	ZM103248	*
4"	4" BSPT	ZM103264	*

Ver precios en Tarifa Inox p.172 / Prices in Stainless Steel Catalogue p.172 / Prix dans le Catalogue Acier Inox p.172 / Prezzi in Acciaio Inossidabile p.172

# Racores y Bridas soldables

*Welding fittings and forged flanges*  
*Raccords et brides à souder*  
*Raccordi e flange a saldare*

## Brida fija DIN 2633 PN 10/16

*Fixed forged flange DIN 2633 PN 10/16*

*Bride fixe avec collerette DIN 2633 PN 10/16 à souder*

*Flangia fissa a saldare DIN 2633 PN 10/16*

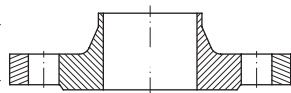

DN	Part nº Referencia	€
3/8"	BPN16263306	12,87
1/2"	BPN16263308	16,45
3/4"	BPN16263312	24,04
1"	BPN16263316	25,33
1"1/4	BPN16263320	27,31
1"1/2	BPN16263324	30,00
2"	BPN16263332	38,06
2"1/2	BPN16263340	59,56
3"	BPN16263348	66,93
4"	BPN16263364	83,63

## Brida ANSI-ASA Neck 150 LBS

*Flange ANSI-ASA w.Neck 150 LBS*

*Bride ANSI-ASA w. Neck 150 LBS*

*Flangia ANSI-ASA 150 LBS*

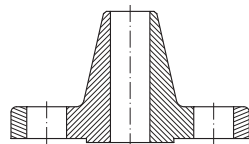

DN	Part nº Referencia	€
1/2"	BANSAWN15008	16,60
3/4"	BANSAWN15012	16,42
1"	BANSAWN15016	19,47
1"1/4	BANSAWN15020	23,91
1"1/2	BANSAWN15024	29,25
2"	BANSAWN15032	37,44
2"1/2	BANSAWN15040	48,12
3"	BANSAWN15048	54,06
4"	BANSAWN15064	76,47

## Brida fija DIN 2635 PN 40

*Fixed forged flange DIN 2635 PN 40*

*Bride fixe avec collerette DIN 2635 PN 40 à souder*

*Flangia fissa a saldare DIN 2635 PN 40*

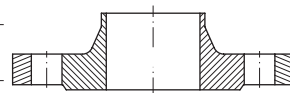

DN	Part nº Referencia	€
3/8"	BPN40263506	3,98
1/2"	BPN40263508	7,68
3/4"	BPN40263512	10,97
1"	BPN40263516	13,29
1"1/4	BPN40263520	18,19
1"1/2	BPN40263524	22,58
2"	BPN40263532	25,48
2"1/2	BPN40263540	48,06
3"	BPN40263548	58,63
4"	BPN40263564	54,71

## Brida ANSI-ASA Neck 300 LBS

*Flange ANSI-ASA w.Neck 300 LBS*

*Bride ANSI-ASA w. Neck 300 LBS*

*Flangia ANSI-ASA Neck 300 LBS*

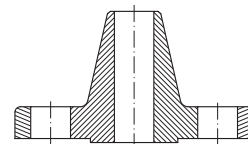

DN	Part nº Referencia	€
1/2"	BANSAWN30008	16,55
3/4"	BANSAWN30012	22,59
1"	BANSAWN30016	21,82
1"1/4	BANSAWN30020	29,15
1"1/2	BANSAWN30024	34,38
2"	BANSAWN30032	39,84
2"1/2	BANSAWN30040	43,42
3"	BANSAWN30048	83,92
4"	BANSAWN30064	128,66

Industrial hoses

Industrial fittings

Stainless steel hose, welding fittings and forged flanges

Low pressure

Air conditioning hoses and fittings

# Racores y Bridas soldables

Welding fittings and forged flanges  
Raccords et brides à souder  
Raccordi e flange a saldare

## Brida loca DIN 2642 PN 10/16

Swivel forged flange DIN 2642 PN 10/16

Bride plate tournante DIN 2642 PN 10/16 à souder

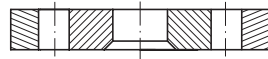

Flangia girevole a saldare DIN 2642 PN 10/16

DN	Part nº Referencia	€
3/8"	BPN10264206	8,20
1/2"	BPN10264208	9,45
3/4"	BPN10264212	11,04
1"	BPN10264216	13,89
1"1/4	BPN10264220	20,49
1"1/2	BPN10264224	23,34
2"	BPN10264232	27,55
2"1/2	BPN10264240	32,79
3"	BPN10264248	41,56
4"	BPN10264264	46,00

## Aro para brida DIN 2642

Ring for flange DIN 2642

Collet épais pour bride DIN 2642

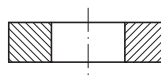

Anello per flangia DIN 2642

DN	Part nº Referencia	€
3/8"	ABARO264206	4,61
1/2"	ABARO264208	6,01
3/4"	ABARO264212	7,03
1"	ABARO264216	10,92
1"1/4	ABARO264220	14,16
1"1/2	ABARO264224	12,40
2"	ABARO264232	18,62
2"1/2	ABARO264240	18,72
3"	ABARO264248	24,54
4"	ABARO264264	59,54

## Tubo soldar brida ANSI-DIN

Tube for welding flanges ANSI-DIN

Tube à souder brides ANSI-DIN

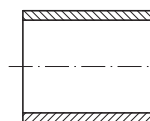

Tube per flangia a saldare ANSI-DIN

DN	Part nº Referencia	€
3/8"	ABTUB006	2,22
1/2"	ABTUB008	2,51
3/4"	ABTUB012	2,84
1"	ABTUB016	3,45
1"1/4	ABTUB020	4,37
1"1/2	ABTUB024	5,92
2"	ABTUB032	7,36
2"1/2	ABTUB040	8,97
3"	ABTUB048	10,19
4"	ABTUB064	12,34

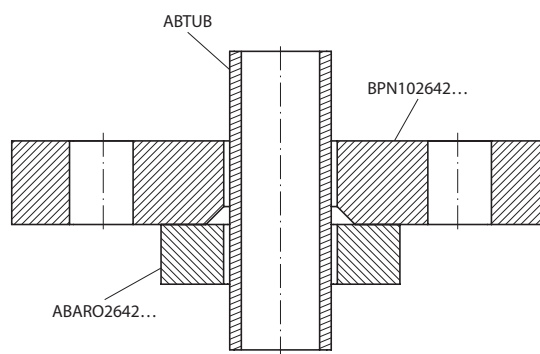

# Racores y Bridas soldables

*Welding fittings and forged flanges*  
*Raccords et brides à souder*  
*Raccordi e flange a saldare*

## Brida loca DIN 2656 PN 40

*Swivel forged flange DIN 2656 PN 40*

*Bride plate tournante DIN 2656 PN 40 à souder*

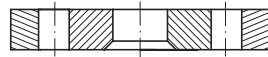

*Flangia girevole a saldare DIN 2656 PN 40*

DN	Part nº Referencia	€
3/8"	BPN40265606	6,00
1/2"	BPN40265608	6,57
3/4"	BPN40265612	7,95
1"	BPN40265616	10,67
1"1/4	BPN40265620	17,03
1"1/2	BPN40265624	24,01
2"	BPN40265632	31,76
2"1/2	BPN40265640	36,60
3"	BPN40265648	30,84
4"	BPN40265664	59,85

## Aro para brida DIN 2656

*Ring for flange DIN 2656*

*Collet épais pour bride DIN 2656*

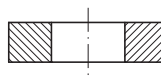

*Anello per flangia DIN 2656*

DN	Part nº Referencia	€
3/8"	ABARO265606	6,09
1/2"	ABARO265608	7,55
3/4"	ABARO265612	7,11
1"	ABARO265616	9,61
1"1/4	ABARO265620	10,24
1"1/2	ABARO265624	11,94
2"	ABARO265632	17,96
2"1/2	ABARO265640	21,48
3"	ABARO265648	33,46

## Tubo soldar brida ANSI-DIN

*Tube for welding flanges ANSI-DIN*

*Tube à souder brides ANSI-DIN*

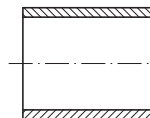

*Tube per flangia a saldare ANSI-DIN*

DN	Part nº Referencia	€
3/8"	ABTUB006	2,22
1/2"	ABTUB008	2,51
3/4"	ABTUB012	2,84
1"	ABTUB016	3,45
1"1/4	ABTUB020	4,37
1"1/2	ABTUB024	5,92
2"	ABTUB032	7,36
2"1/2	ABTUB040	8,97
3"	ABTUB048	10,19
4"	ABTUB064	12,34

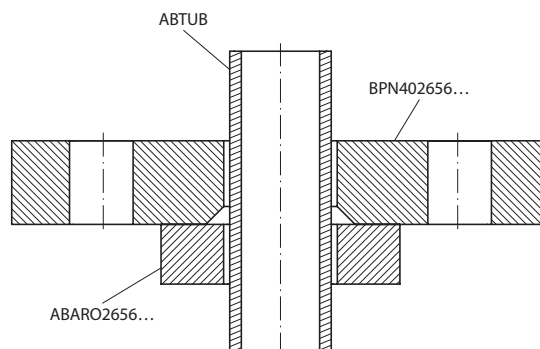

# Racores y Bridas soldables

*Welding fittings and forged flanges*  
*Raccords et brides à souder*  
*Raccordi e flange a saldare*

## Brida loca ANSI-ASA 150 LBS

*Swivel flange ANSI-ASA 150 LBS*

*Bride tourn. ANSI-ASA 150 LBS*



*Flangia ANSI-ASA 150 LBS*

DN	Part nº Referencia	€
1/2"	BANSASO15008	12,61
3/4"	BANSASO15012	7,77
1"	BANSASO15016	8,16
1"1/4	BANSASO15020	10,76
1"1/2	BANSASO15024	18,97
2"	BANSASO15032	30,09
2"1/2	BANSASO15040	35,55
3"	BANSASO15048	42,70
4"	BANSASO15064	53,09

## Brida loca ANSI-ASA 300 LBS

*Swivel flange ANSI-ASA 300 LBS*

*Bride tourn. ANSI-ASA 300 LBS*



*Flangia ANSI-ASA 300 LBS*

DN	Part nº Referencia	€
1/2"	BANSASO30008	11,50
3/4"	BANSASO30012	19,47
1"	BANSASO30016	14,16
1"1/4	BANSASO30020	17,70
1"1/2	BANSASO30024	26,58
2"	BANSASO30032	30,55
2"1/2	BANSASO30040	33,66
3"	BANSASO30048	47,17
4"	BANSASO30064	77,14

## Tubo soldar brida ANSI-DIN

*Tube for welding flanges ANSI-DIN*

*Tube à souder brides ANSI-DIN*

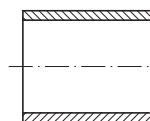

*Tubo per flangia a saldare ANSI-DIN*

DN	Part nº Referencia	€
3/8"	ABTUB006	2,22
1/2"	ABTUB008	2,51
3/4"	ABTUB012	2,84
1"	ABTUB016	3,45
1"1/4	ABTUB020	4,37
1"1/2	ABTUB024	5,92
2"	ABTUB032	7,36
2"1/2	ABTUB040	8,97
3"	ABTUB048	10,19
4"	ABTUB064	12,34

## Aro para brida ANSI-ASA 150/300 LBS

*Ring for welding flanges ANSI-ASA 150/300 LBS*

*Collet épais pour bride ANSI-ASA 150/300 LBS*

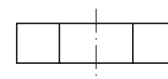

*Anello per flangia ANSI-ASA 150/300 LBS*

DN	Part nº Referencia	€
1/2"	ABAROANSA08	3,28
3/4"	ABAROANSA12	3,94
1"	ABAROANSA16	6,91
1"1/4	ABAROANSA20	5,89
1"1/2	ABAROANSA24	7,48
2"	ABAROANSA32	12,44
2"1/2	ABAROANSA40	16,01
3"	ABAROANSA48	21,01
4"	ABAROANSA64	35,03

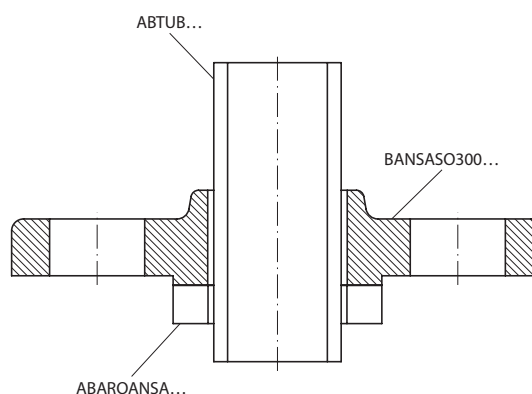
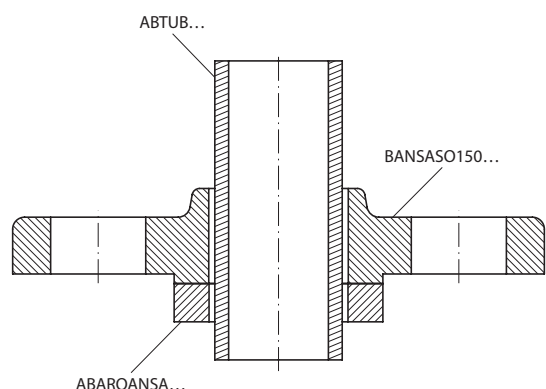



# MONTAJE DE LATIGUILLOS *MOUNTING FLEXIBLES*

